

## Model: CSP-A390

### Inline Cabinet Fan

#### Standard Construction Features:

- Corrosion resistant galvanized steel scroll and housing - Sound absorbing insulation - Rectangular inlet and outlet duct collar - Outlet with integral spring loaded back draft damper - Double inlet forward curved wheel - Plug type disconnect - Adjustable mounting brackets - Field rotatable discharge

#### Stock Notes

- Units are stocked with 115/60/1 motors
- All CSP fans require 5 watt speed controller, Model CSP-A1050 and CSP-A1401 require 10W speed controller

#### Available Accessories

- Wall and discharge accessories
- Vibration isolation kit
- Speed control

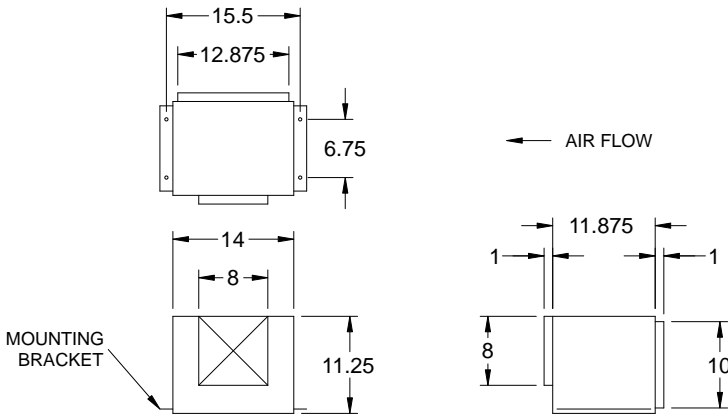

Dimensional	
Quantity	1
Weight w/o Acc's (lb)	23
Weight w/ Acc's (lb)	23

Motor	
Motor Mounted	Yes
** Input Watts (W)	149
Voltage/Cycle/Phase	115/60/1
Enclosure	ODP

Model	Control Voltage	RPM	Amps*	Max. Input Watts*	CFM / Static Pressure in Inches wg											
					0	0.1	0.125	0.25	0.375	0.5	0.625	0.75	0.875	1.0	1.25	
CSP-A390		1350	1.33	161	CFM	412	400	397	382	363	339	324	309			
					Sones	2.0	2.0	2.0	2.5	3.0	4.0	4.5	4.5			
					Watts*	160.8	158.5	157.9	152.4	147.9	141.8	135.4	130.0			