

Model: G-095-D

Direct Drive Centrifugal Roof Exhaust Fan

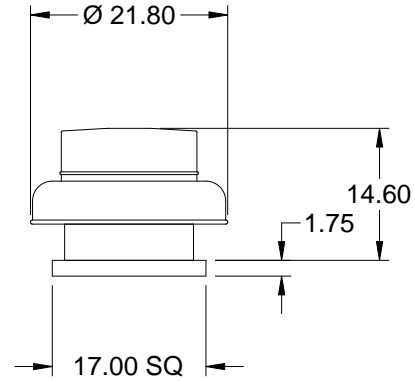

OVERALL HEIGHT MAY BE GREATER DEPENDING ON MOTOR.

Dimensional	
Quantity	1
Weight w/o Acc's (lb)	28
Weight w/ Acc's (lb)	34
Roof Opening (in.)	12.5 x 12.5
Damper Size	10 x 10
Roof Curb	GPI - 17

Motor	
Motor Mounted	Yes
Size (hp)	1/8, 1/12, 1/30
Voltage/Cycle/Phase	115/60/1
Enclosure	ODP
Motor RPM	1550, 1300, 1050
Efficiency Rating	Standard
Windings	1

Note: Fan is provided with 3 speed motor

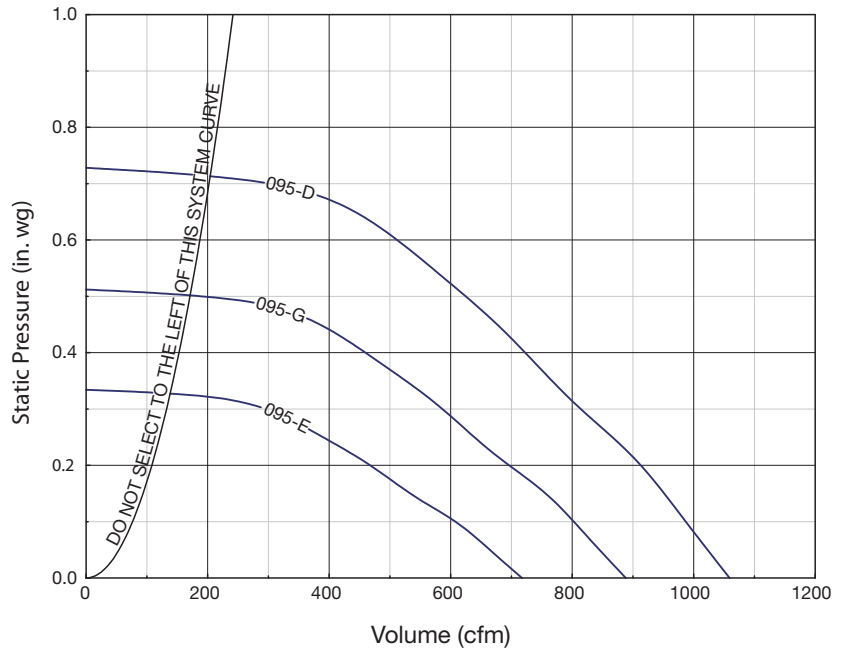

Motor HP	Fan RPM	Static Pressure in Inches wg										
		0	0.1	0.125	0.15	0.2	0.25	0.3	0.375	0.5	0.625	
095												
E-1/30	1050	CFM	717	606	570	534	468	389	290			
		BHP	0.03	0.03	0.04	0.04	0.04	0.04	0.03			
		Sones	5.4	4.5	4.5	4.5	4.4	4.5	4.6			
G-1/12	1300	CFM	888	802	780	754	695	640	586	493	184	
		BHP	0.06	0.06	0.06	0.06	0.07	0.07	0.07	0.07	0.05	
		Sones	7.6	6.8	6.7	6.6	6.5	6.4	6.4	6.4	6.8	
D-1/8	1550	CFM	1059	987	969	950	912	863	814	745	623	474
		BHP	0.10	0.10	0.10	0.11	0.11	0.11	0.11	0.11	0.12	0.11
		Sones	9.6	9.4	9.3	9.2	9	8.8	8.7	8.7	8.7	8.7